

The Sinclair

2,400 sqft, 4 bedrooms, 2/3 baths

The Sinclair features the popular "pocket office" up front and an oversized island in the kitchen with a spacious corner pantry. Shown with the walk in shower option, the master bath also has an option for a separate jetted tub. The upper level can have an expanded loft area at the top of the stairs and has been built with a third bath creating a second master area. Another popular option is a covered or screened porch off the dining area. Both sides of the home are expandable if extra room is needed in the master or secondary bedrooms.

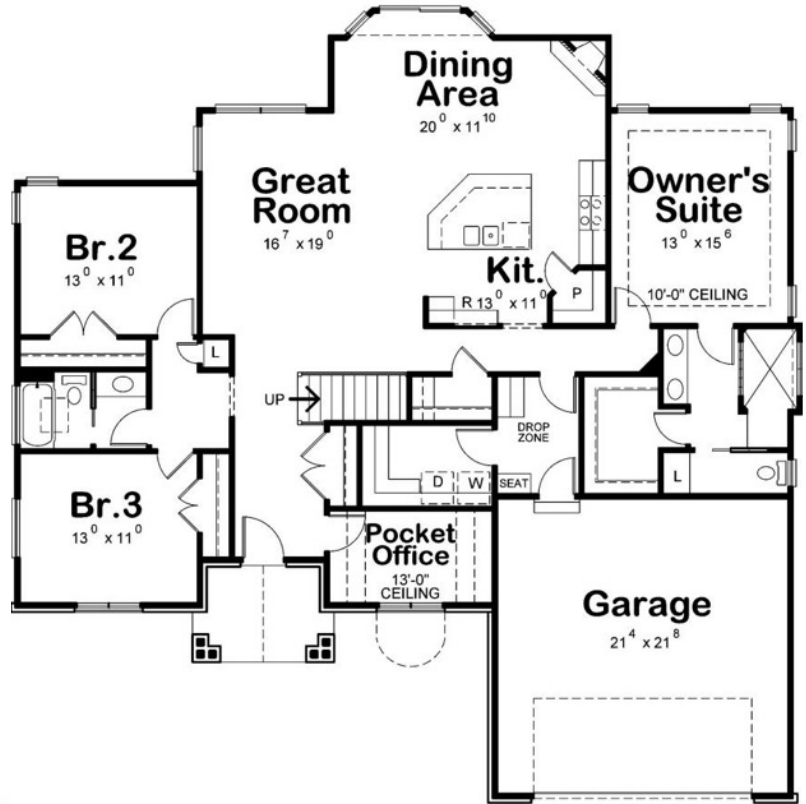

"The builder who always welcomes your call."
(757) 537-7167

